

# Product Data Sheet

## Elastodrain® EL 202

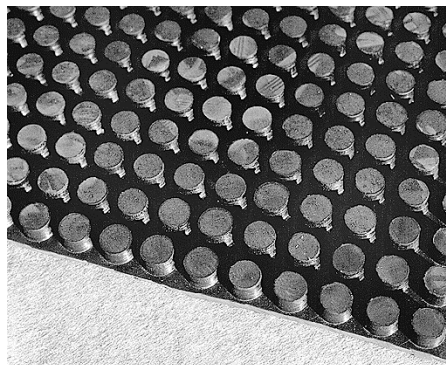

Protection and drainage sheet with extremely high loadability; designed for use under driveways, access roads for fire brigades, parking areas, etc.

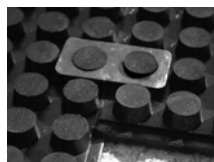

The EL 202-panels can be fixed with detachable connectors.

### Technical Data

#### Elastodrain® EL 202

Compression moulded building protection and drainage sheet of solid, vulcanized rubber, with a rebated edge and one-sided stud structure. The boards can be inter-connected with special EL 202-Connectors.

Colour: black  
 Height: ca. 19 mm  
 Stud height: ca. 12 mm  
 Number of studs: ca. 1200 /m<sup>2</sup>  
 Weight: ca. 18 kg/m<sup>2</sup>

Compressive strength at 10% compression: ca. 400 kN/m<sup>2</sup>  
 Shore-strength: ca. 75 Shore A  
 Static foundation support module: ca. 285 MN/m<sup>3</sup>  
 Heat resistance: up to 200° C, briefly up to > 250° C

In-plane water flow capacity (EN ISO 12958):  
 roof slope 1%: ca. 0.34 l/(s·m)  
 roof slope 2%: ca. 0.47 l/(s·m)  
 roof slope 3%: ca. 0.57 l/(s·m)

Dimensions: ca. 1.00 m x 1.00 m

Accessories:  
 Rubber 2-hole Connector Order No. 3221

### Features

- extremely high mechanical loadability
- step joint edging
- protection layer according to German Standard DIN 18 195
- drainage effect according to German Standard DIN 4095
- "spade resistant"
- reduces subsonic noise
- high stability even during storms
- quick and easy installation
- joint connector as accessory available

### Application Example

#### "Driveway for Cars"

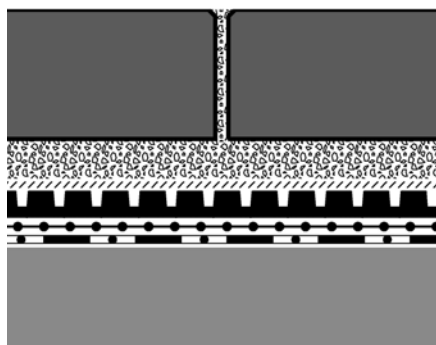

Slabs in chipping bedding

Filter Sheet PV  
 Elastodrain® EL 202  
 Slip Sheet TGF 20

Roof construction with root resistant waterproofing

### Specification Suggestion

Trafficable protection and drainage sheet of solid, vulcanized rubber, with a step joint edging and a one-sided stud structure, weight ca. 18 kg/m<sup>2</sup>, stud height ca. 12 mm, total height ca. 19 mm, Shore-strength 75 Shore A, static foundation support module ca. 285 MN/m<sup>3</sup>, in-plane water flow capacity tested

according to EN ISO 12958, delivery and installation to manufacturer's instructions, to be fixed with two detachable connectors per meter.

Make: ZinCo Elastodrain® EL 202  
 Enquiries: ZinCo GmbH,  
 Phone: +49 7022 6003-0

